

**CONDUIT PLAN CROSSING**  
NOT TO SC-LE

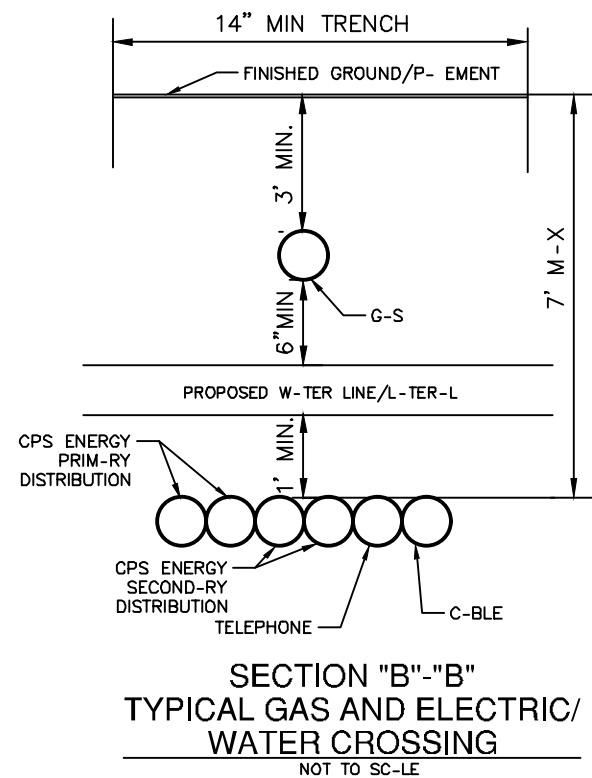

**SECTION "B"-"B"**  
**TYPICAL GAS AND ELECTRIC/  
WATER CROSSING**  
NOT TO SC-LE

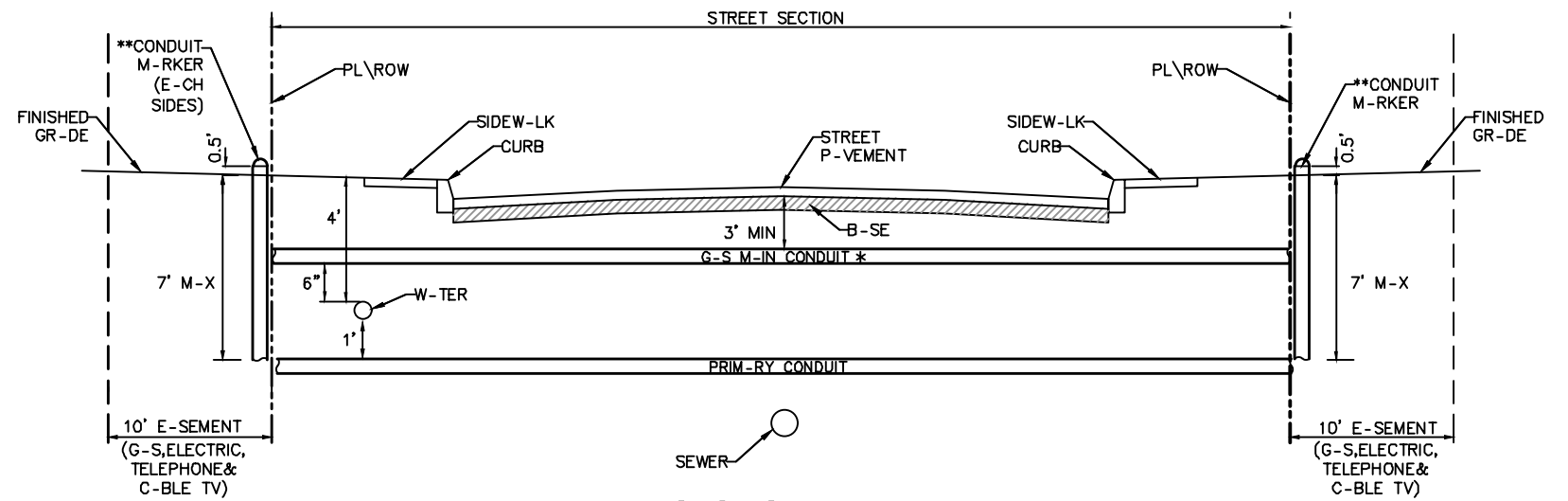

**SECTION "A"-"A"**  
**CONDUIT PLAN CROSSING**  
NOT TO SC-LE

\* IN C-SES WHERE INSTALL-TION IS AN ELECTRIC ONLY OR - G-S ONLY INSTALL-TION, THE CONDUITS SHOULD BE PLACED IN THE 'GAS M-IN CONDUIT' POSITION TO MEET 3' OF COVER REQUIREMENT.

\*\* CONDUIT M-RKERS -RE TO BE INSTALLED -T CONDUIT ENDS FOR EASE OF LOCATION BY CPS ENERGY CREWS.

PLEASE NOTE THAT THESE CROSSING DETAILS APPLY TO MOST PROJECTS WITHIN THE S-WS & COUNTY PROJECTS. ANY DRY TO WET UTILITY CROSSING REQUIREMENTS SHOULD BE VERIFIED WITH CPS ENERGY AND THE WATER DISTRICT'S REQUIREMENTS.

**IMPORTANT**  
**EXCAVATION SAFETY PLAN AND PROCEDURES**

THE CONTR-CTOR -ND/OR CONTRACTOR'S INDEPENDENTLY RETAINED EMPLOYEE OR SAFETY CONSULT-NT SH-LL REVIEW THESE PL-NS, CONSTRUCTION SKETCHES, SPECIFICATIONS -ND ANTICIPATED EXC-V-TION SITES WITHIN THE PROJECT WORK ARE- IN ORDER TO DEVELOP THE CONTRACTOR'S EXCAVATION S-FETY PLAN AND PROCEDURES. THE EXCAVATION SAFETY PLAN -ND PROCEDURES SHALL MEET OR EXCEED ALL REQUIREMENTS AS IDENTIFIED IN THE OCCUPATION S-FETY -ND HEALTH -DMINISTR-TION (OSHA) STANDARD 29 CFR PART 1926 SUBP-RT P-EXCAVATIONS (7-1-94 EDITION). SPECIFICALLY, THE CONTRACTOR AND/OR THE CONTRACTOR;S INDEPENDENTLY RETAINED EMPLOYEE OR S-FETY CONSULTANT SHALL DEVELOP AND IMPLEMENT AN EXC-V-TION SAFETY PROGRAM IN ACCORD-NCE WITH OSH-'S ST-NDARDS GOVERNING THE PRESENCE -ND -CTIVITIES OF INDIVIDU-LS WORKING IN AND AROUND -NY EXC-V-TION.

**TYPICAL GAS/ELECTRIC DETAIL**

SHEET 1 OF 3

U-S-202 REVISION DATE: 4-13-23  
CPS ENERGY CROSSING DETAILS  
RESIDENTIAL DEVELOPMENT DEPT.



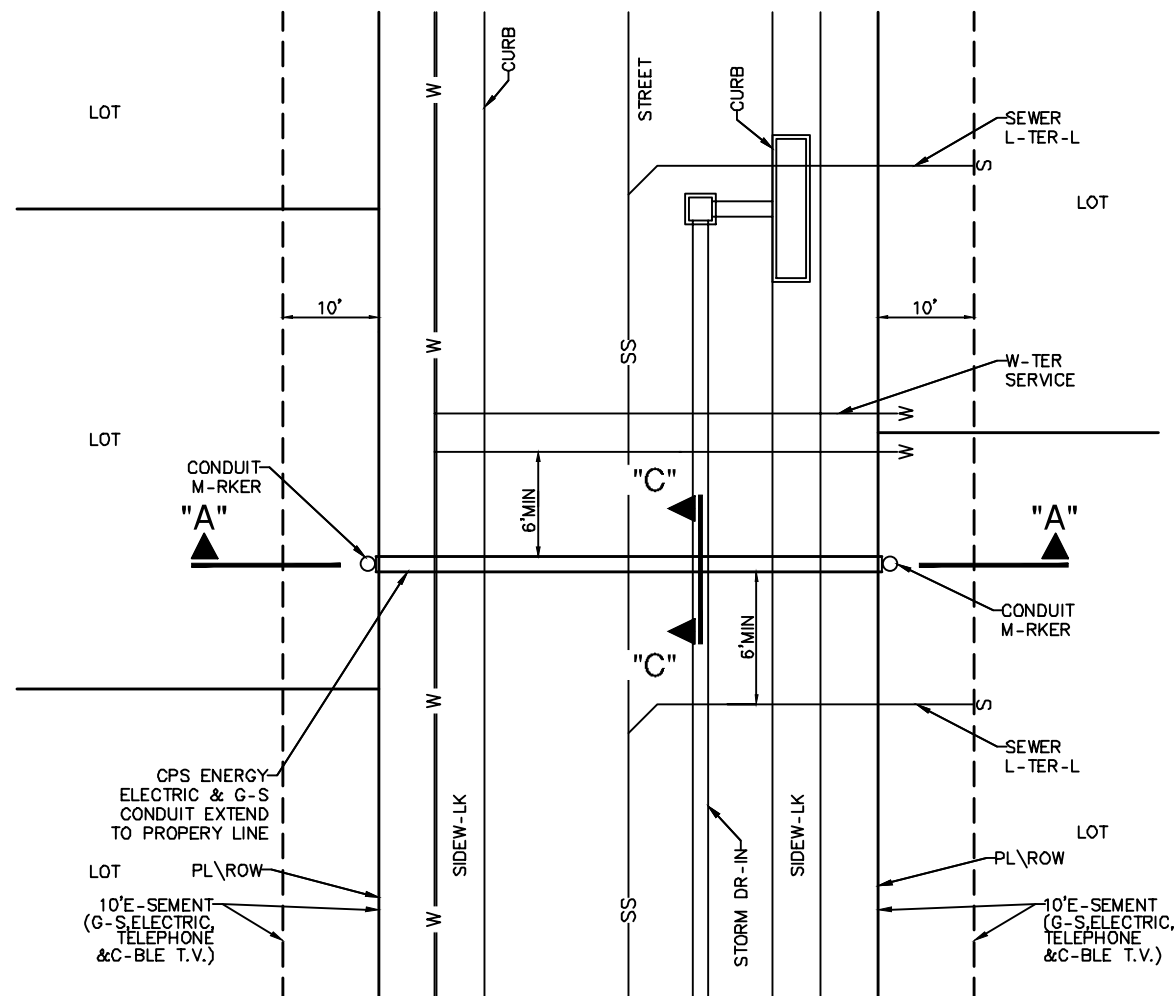

**CONDUIT PLAN CROSSING**  
NOT TO SC-LE

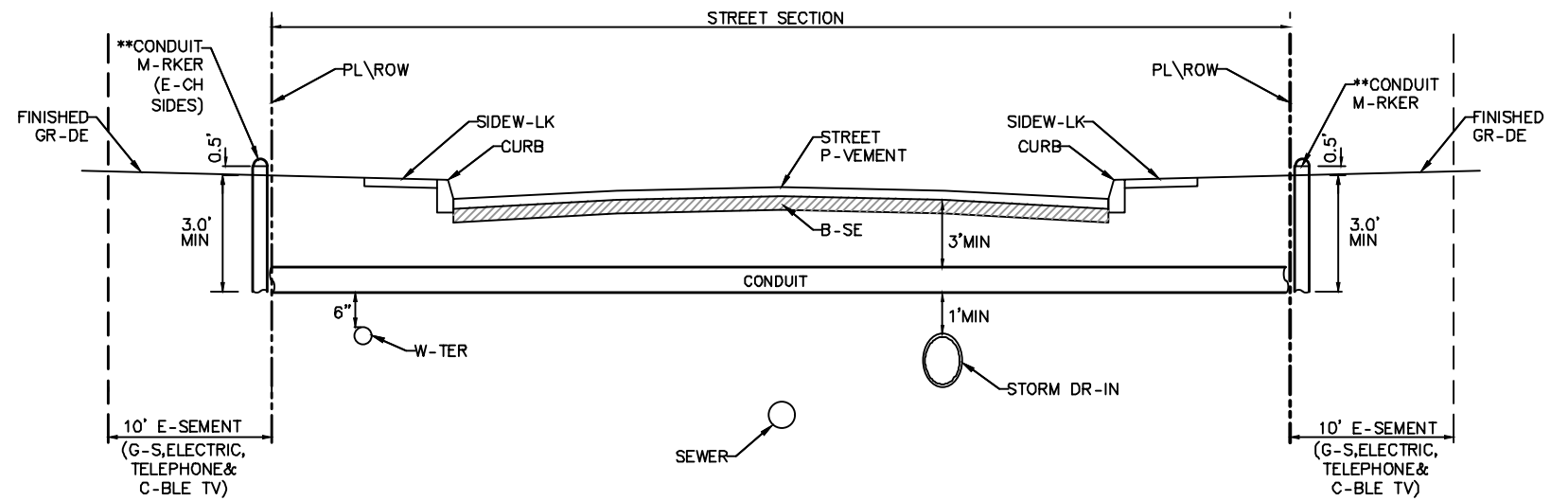

**SECTION "A"- "A"**  
**CONDUIT PLAN CROSSING**  
NOT TO SC-LE

\*\* CONDUIT MARKERS ARE TO BE INST-LLED AT CONDUIT ENDS FOR EASE OF LOC-TION BY CPS ENERGY CREWS.

PLEASE NOTE TH-T THESE CROSSING DETAILS -PPLY TO MOST PROJECTS WITHIN THE S-WS & COUNTY PROJECTS. ANY DRY TO WET UTILITY CROSSING REQUIREMENTS SHOULD BE VERIFIED WITH CPS ENERGY AND THE W-TER DISTRICT'S REQUIREMENTS.

**IMPORTANT**  
**EXCAVATION SAFETY PLAN AND PROCEDURES**

THE CONTR-CTOR -ND/OR CONTRACTOR'S INDEPENDENTLY RETAINED EMPLOYEE OR SAFETY CONSULT-NT SH-LL REVIEW THESE PL-NS, CONSTRUCTION SKETCHES, SPECIFICATIONS -ND ANTICIPATED EXC-V-TION SITES WITHIN THE PROJECT WORK ARE- IN ORDER TO DEVELOP THE CONTRACTOR'S EXCAVATION S-FETY PLAN AND PROCEDURES. THE EXCAVATION SAFETY PLAN -ND PROCEDURES SHALL MEET OR EXCEED ALL REQUIREMENTS AS IDENTIFIED IN THE OCCUPATION S-FETY -ND HEALTH -DMINISTR-TION (OSHA) STANDARD 29 CFR PART 1926 SUBP-RT P-EXCAVATIONS (7-1-94 EDITION). SPECIFICALLY, THE CONTRACTOR AND/OR THE CONTRACTOR'S INDEPENDENTLY RETAINED EMPLOYEE OR S-FETY CONSULTANT SHALL DEVELOP AND IMPLEMENT AN EXC-V-TION SAFETY PROGRAM IN ACCORD-NCE WITH OSH-'S ST-NDARDS GOVERNING THE PRESENCE -ND -CTIVITIES OF INDIVIDU-LS WORKING IN AND AROUND -NY EXC-V-TION.

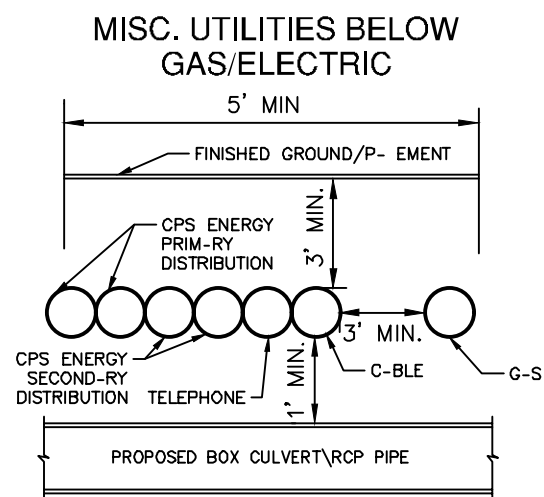

**SECTION "C"- "C"**  
**TYPICAL GAS AND ELECTRIC/ DRAINAGE CROSSING**  
NOT TO SC-LE

**MISC. UTILITIES BELOW GAS/ELECTRIC**

U-S-202 REVISION DATE: 4-13-23  
CPS ENERGY CROSSING DETAILS  
RESIDENTIAL DEVELOPMENT DEPT.



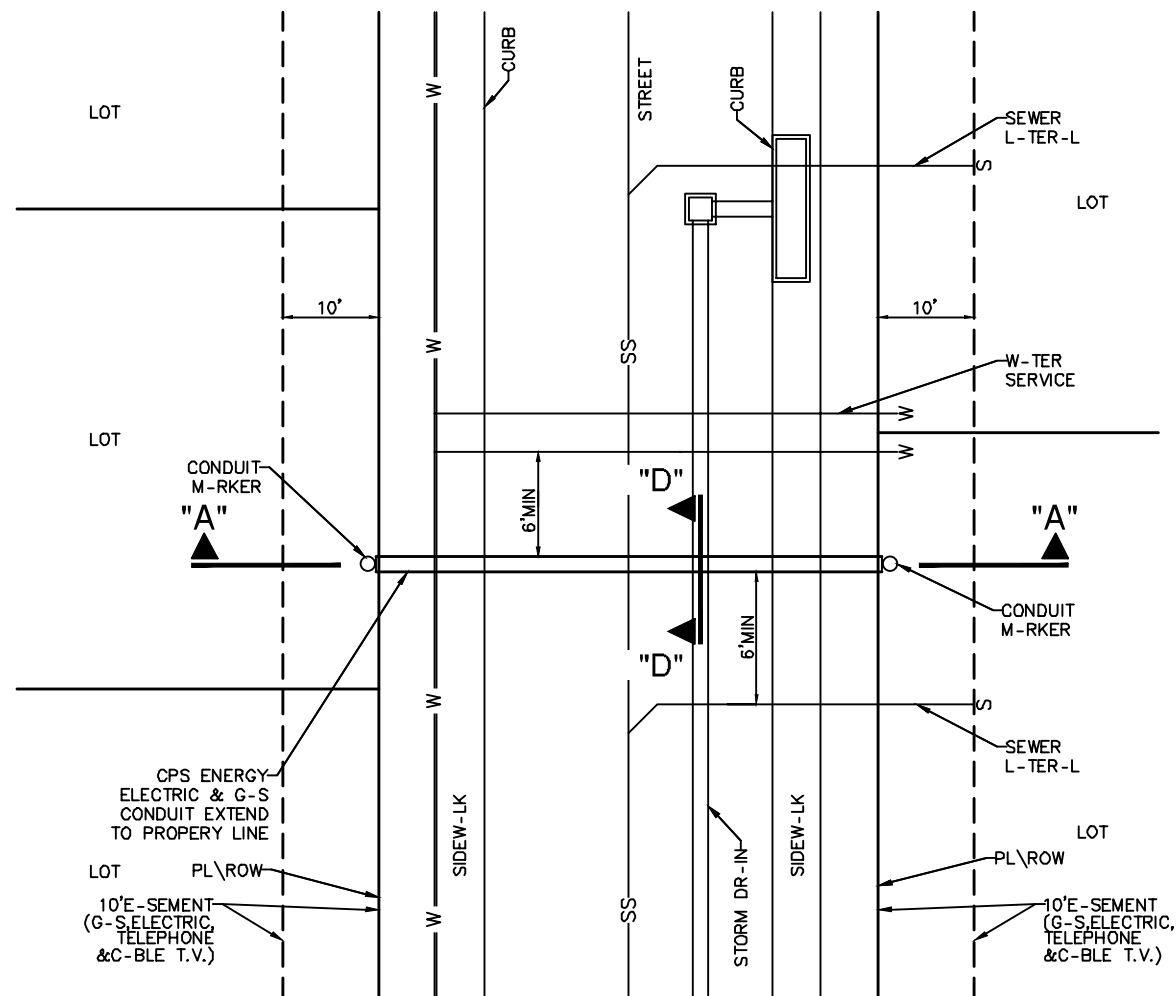

**CONDUIT PLAN CROSSING**  
NOT TO SC-LE

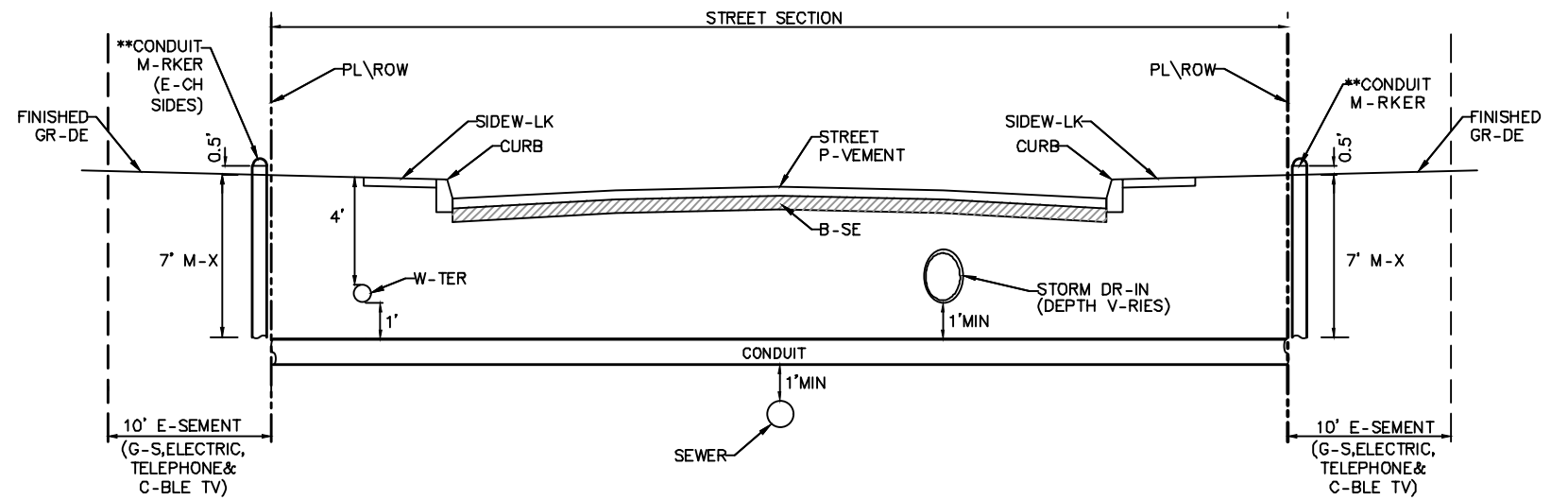

**SECTION "A"- "A"**  
**CONDUIT PLAN CROSSING**  
NOT TO SC-LE

\*\* CONDUIT M-RKERS ARE TO BE INST-LLED AT CONDUIT ENDS FOR EASE OF LOC-TION BY CPS ENERGY CREWS.

PLEASE NOTE TH-T THESE CROSSING DETAILS -PPLY TO MOST PROJECTS WITHIN THE S-WS & COUNTY PROJECTS. -NY DRY TO WET UTILITY CROSSING REQUIREMENTS SHOULD BE VERIFIED WITH CPS ENERGY AND THE W-TER DISTRICT'S REQUIREMENTS.

**IMPORTANT**  
**EXCAVATION SAFETY PLAN AND PROCEDURES**

THE CONTR-CTOR -ND/OR CONTRACTOR'S INDEPENDENTLY RETAINED EMPLOYEE OR SAFETY CONSULT-NT SH-LL REVIEW THESE PL-NS, CONSTRUCTION SKETCHES, SPECIFICATIONS -ND ANTICIPATED EXC-V-TION SITES WITHIN THE PROJECT WORK ARE- IN ORDER TO DEVELOP THE CONTRACTOR'S EXCAVATION S-FETY PLAN AND PROCEDURES. THE EXCAVATION SAFETY PLAN -ND PROCEDURES SHALL MEET OR EXCEED ALL REQUIREMENTS AS IDENTIFIED IN THE OCCUPATION S-FETY -ND HEALTH -DMINISTR-TION (OSHA) STANDARD 29 CFR PART 1926 SUBP-RT P-EXCAVATIONS (7-1-94 EDITION). SPECIFICALLY, THE CONTRACTOR AND/OR THE CONTRACTOR'S INDEPENDENTLY RETAINED EMPLOYEE OR S-FETY CONSULTANT SHALL DEVELOP AND IMPLEMENT AN EXC-V-TION SAFETY PROGRAM IN ACCORD-NCE WITH OSH-'S ST-NDARDS GOVERNING THE PRESENCE -ND -CTIVITIES OF INDIVIDU-LS WORKING IN AND AROUND -NY EXC-V-TION.

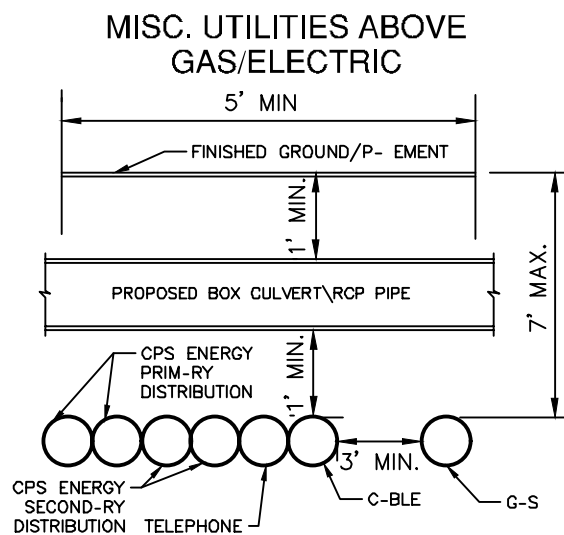

**SECTION "D"- "D"**  
**TYPICAL GAS AND ELECTRIC/ DRAINAGE CROSSING**  
NOT TO SC-LE

**MISC. UTILITIES ABOVE GAS/ELECTRIC**

U-S-202 REVISION DATE: 4-13-23  
CPS ENERGY CROSSING DETAILS  
RESIDENTIAL DEVELOPMENT DEPT.

